

THOMAS H  
WOOD

26, Lawrenny Avenue,  
Leckwith,  
Cardiff,  
CF11 8BP

2 Bed House - Terraced

£950



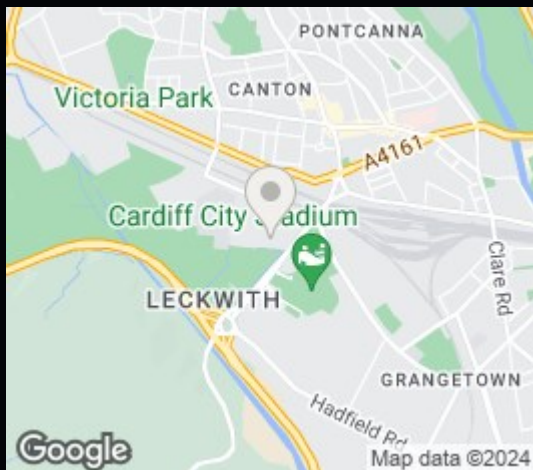

A traditional two bedroom mid terrace house located in this most convenient of central locations within 400m of both Leckwith retail park and the Cardiff City stadium. Newly decorated with brand new carpets throughout this solid property also enjoys the benefit of being over the road from the popular Fitzalan High School. Unfurnished with cooking appliances. On road parking. Front and rear gardens. Available April 2024 for minimum twelve month initial term.



2



1



1



C

£950

CONTACT

EMAIL

[lettings@thomashwood.com](mailto:lettings@thomashwood.com)

TELEPHONE

02920 626252

WEBSITE

Energy Efficiency Rating		
	Current	Potential
Very energy efficient - lower running costs		
(92 plus) <b>A</b>		
(81-91) <b>B</b>		
(69-80) <b>C</b>	69	87
(55-68) <b>D</b>		
(39-54) <b>E</b>		
(21-38) <b>F</b>		
(1-20) <b>G</b>		
Not energy efficient - higher running costs		
<b>England &amp; Wales</b>	EU Directive 2002/91/EC	

**Ground Floor**  
Approx. 306.8 sq. feet

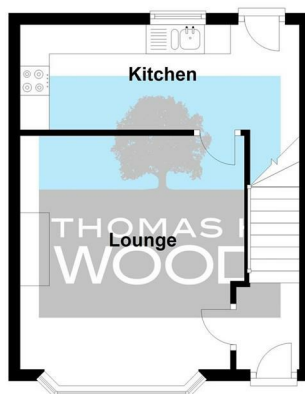

**First Floor**  
Approx. 303.6 sq. feet

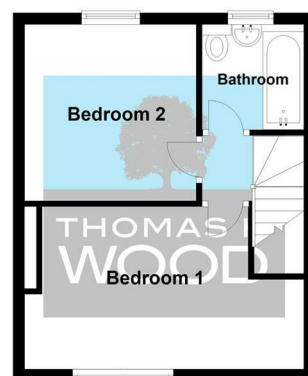

Total area: approx. 610.4 sq. feet